

AILE[®]

WORLD FAMOUS BRANDS



AILE[®]

SHANGHAI
AILE PETROLEUM
EQUIPMENT
MFG.CO.,LTD.

• Automatic nozzles series

Automatic Nozzles



A2101-11A Series Of Automatic Nozzles

► **AILE®** A2101-11A series of automatic nozzles are designed for today's customers' demands. Small, trim, light weight, easy and convenient to operate, the AILE A2101-11A is a rugged performer that offers long life and reliable service.

► **Materials:**
Body: Aluminum
Seals: Buna-N, Viton
Main stem seals: Viton Cased Oil Seal / Graphite with Teflon
Main stem: Stainless steel

► **Package:**
Net Weight: 1.225kg/pc
Gross Weight: 1.5kg/pc
53.7x42.7x35.7 cm³/case of 15pc
37.5x34x43 cm³/case of 10pc

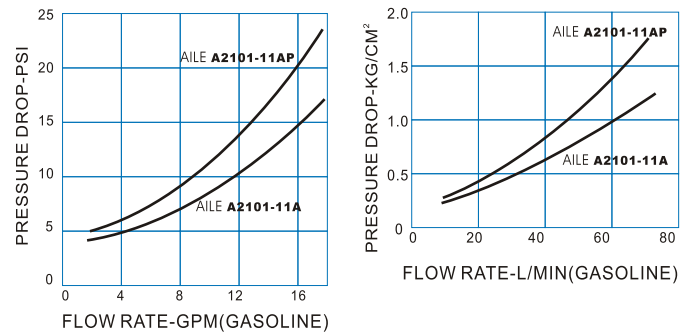

► **Ordering Specifications:**

Product #	Inlet size	Outlet diameter
A2101-11A	BSP3/4"/NPT3/4"	15/16"
A2101-11AP	BSP3/4"/NPT3/4"	13/16"

► **AILE® A2101-11A**



► **Features & Benefits:**

- ◆ **AILE® A2101-11A** Flow rate: 0-60 L/m (¹⁵/₁₆"")
AILE® A2101-11AP Flow rate: 0-45 L/m (¹³/₁₆"")
Working Pressure: 0.18Mpa
- ◆ **AILE A2101-11A Automatic Nozzles-** for diesel, kerosene and all kinds of gasoline service.
- ◆ **Easily replaced spout-** simply removes the screw. Spout kits are available from AILE.
- ◆ **Low-profile aluminum body-** light weight, easier to handle, provides an attractive, image-enhancing appearance.
- ◆ **Vacuum Design:** Back-Sealing Design.
- ◆ **Selective casting process of body-** Sand casting technique or high-pressure casting technique. The high-pressure casting technique can reduce diesel foaming and static electricity.
- ◆ **Patent No:** ZL98247417.2
- ◆ **Hold-open rack is available for full service applications** the one hand control means easy setting to flow rate for customer's convenience.
- ◆ **Full hand insulator-** protects both nozzle and vehicle, and insulates user's hands.
- ◆ **Available Colors-** color chart on inside back cover
- ◆ **Selective splash guard.**
- ◆ **Selective Spout With Flowlock -** designed to shut-off automatically when the spout is tipped up, limiting spillage and " spit "
- ◆ **100% Factory Tested.**

► **Warning:**

Using foreign objects to hold open automatic nozzles could result in failure to shut-off and personal injury.

► **AILE® A2101-11AP**



A2101-11A Series Of Automatic Nozzles

► **AILE® A2101-11A Nozzle Shown**

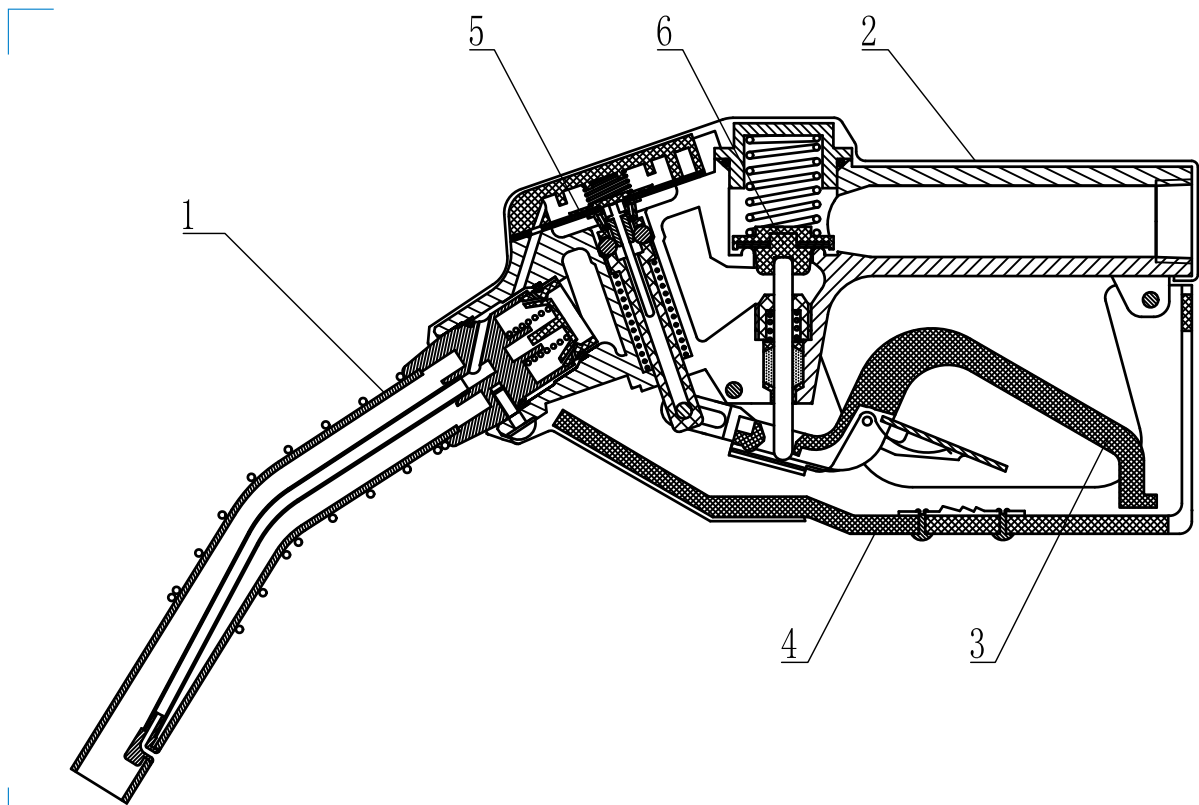

► **Important:**

AILE® Products should be used in compliance with country, province and local Laws and regulations. Products selection should be based on physical specifications and limitations and compatibility with the environment and materials to be handled. AILE Makes no warranty of fitness for a particular use. All illustrations and specifications in this literature are based on the latest products information available at the time of publication, AILE reserves the right to make changes at any time in price, materials. specifications and models and to discontinue models without notice or obligation.

► **Replacement Parts:**

Key	Description	A2101-11A	A2101-11AP
1	Spout 13/16"		◆
1	Spout 15/16"	◆	
2	Full Hand Insulator	◆	◆
3	Lever Assembly	◆	◆
4	Lever Guard	◆	◆
5	Diaphragm Assembly	◆	◆
6	Main Valve Assembly	◆	◆



A2101-11B Series Of Automatic Pressure-Sensitives Nozzles

► **AILE®**A2101-11B series high-quality automatic Nozzles are designed specially for self-service prepay or card-lock system to help prevent gasoline spills. It can not be opened until the pumping system is pressurized and closes automatically when the pressure is removed. This means the AILE A2101-11B series nozzles are closed when placed back in the dispenser storage position.

► **Materials:**
Body: Aluminum
Seals: Buna-N, Viton
Main stem seals:Viton Cased Oil Seal / Graphite with Teflon
Main stem: Stainless steel

► **Package:**
Net Weight: 1.275kg/pc
Gross Weight: 1.5kg/pc
55x34x42.5 cm³/case of 15pc
37.5x34x43 cm³/case of 10pc

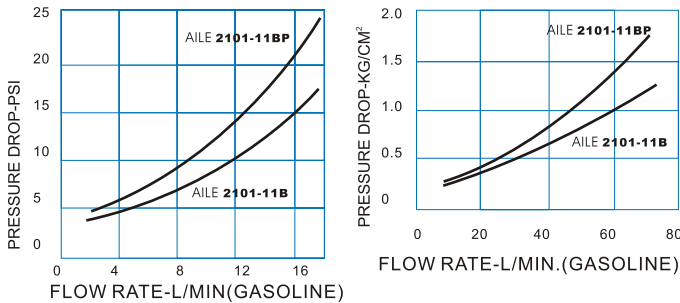

► **Ordering Specifications:**

Product #	Inlet size	Outlet diameter
A2101-11B	NPT3/4" / BSP3/4"	15/16"
A2101-11BP	NPT3/4" / BSP3/4"	13/16"

► **AILE® A2101-11B**



► **Features & Benefits:**

- ◆ **AILE® A2101-11B** Flow rate: 0-60 L/m (¹⁵/₁₆")
AILE® A2101-11BP Flow rate: 0-45 L/m (¹³/₁₆")
- ◆ **Working Pressure:** 0.18Mpa
- ◆ **Accurate flow control-** allows your customers to top off their tank to the exact amount they want , and it's easy to stop gasoline flow precisely.
- ◆ **Easily replaced spout-** simply removes the screw. Spout kits are available from AILE.
- ◆ **Low profile aluminum body-** light weight, easier to handle, provides an attractive, image enhancing appearance.
- ◆ **Hold-open rack is available for full service applications**
The one hand control means easy setting to flow rate for customer's convenience.
- ◆ **Exclusive Pressure Detecting Module-** the main valve can keep closed, even when held without enough pressure in hose.
- ◆ **Full hand insulator-** protects both nozzle and vehicle, and insulates users' hands.
- ◆ **Available Colors-** color chart on inside back cover
- ◆ **Selective splash guard.**
- ◆ **Selective Spout With Flowlock -** designed to shut-off automatically when the spout is tipped up, limiting spillage and " spit "
- ◆ **100% Factory Tested.**

► **Warning:**

Using foreign objects to hold open automatic nozzles could result in failure to shut-off and personal injury.

► **AILE® A2101-11BP**



A2101-11B Series Of Automatic Pressure-Sensitives Nozzles

► **AILE® A2101-11B Nozzle Shown**

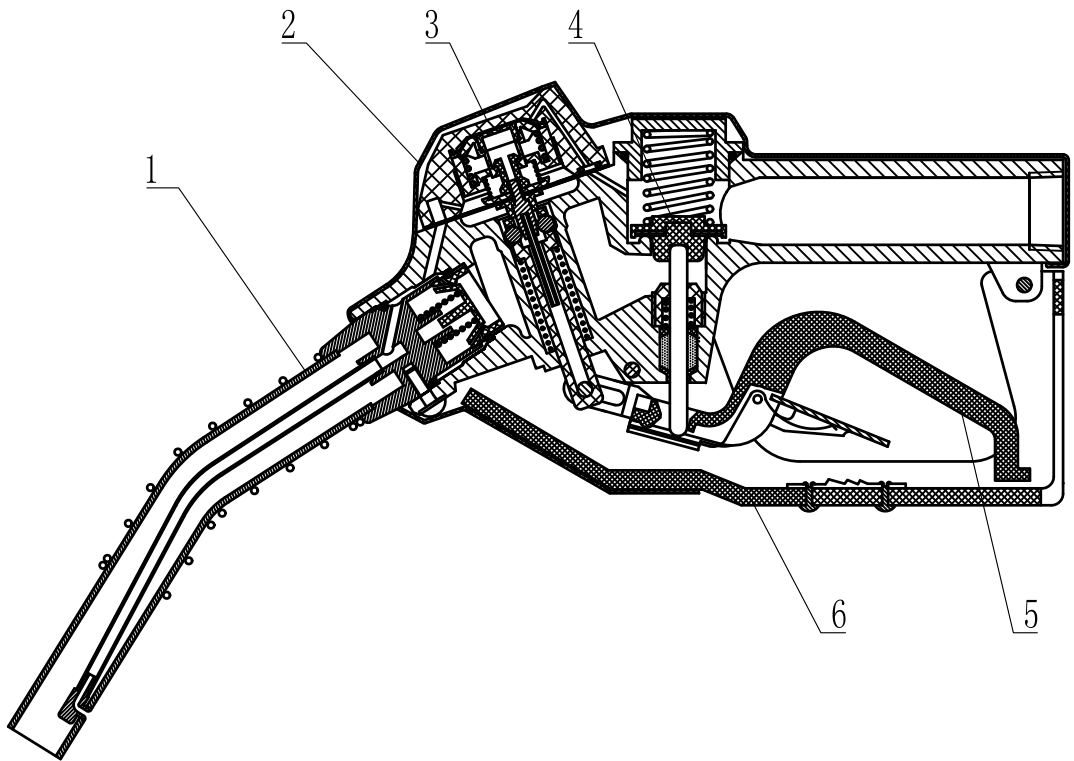

► **Important:**

AILE® Products should be used in compliance with country, province and local Laws and regulations. Products selection should be based on physical specifications and limitations and compatibility with the environment and materials to be handled. AILE Makes no warranty of fitness for a particular use. All illustrations and specifications in this literature are based on the latest products information available at the time of publication, AILE reserves the right to make changes at any time in price, materials. specifications and models and to discontinue models without notice or obligation.

► **Replacement Parts:**

Key	Description	A2101-11B	A2101-11BP
1	Spout 13/16"		◆
1	Spout 15/16"	◆	
2	Full Hand Insulator	◆	◆
3	Vacuum Assembly	◆	◆
4	Main Valve Assembly	◆	◆
5	Lever Assembly	◆	◆
6	lever Guard	◆	◆



120L Series Of Automatic Shut-Off Nozzles

- ▶ For Heavy-Duty, High-Flow Truck stop, Bus and Fleet Service If you operate a full-service truck-stop, refuel your own fleet, or manage a card-lock refueling location, the low cost, long life and durability of the AILE 120L high flow nozzle can help increase your productivity, sales and profits.
- ▶ **Materials:**
Body: Aluminum
Seals: Buna-N, Viton
Main stem seals:Viton Cased Oil Seal / Graphite with Teflon
Main stem: Stainless steel
- ▶ **Package:**
Net Weight: 1.6kg/pc
Gross Weight: 1.9kg/pc
45x40x32.5cm³/case of 10pc

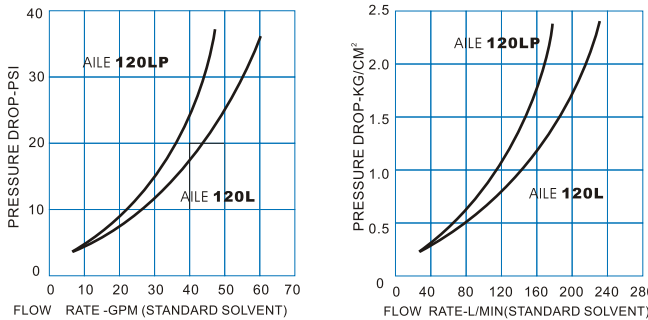

▶ **Ordering Specifications:**

Product #	Inlet size	Outlet diameter
120L	NPT1" / BSP1"	1 ³ / ₁₆ "
120LP	NPT1" / BSP1"	1"

▶ **AILE® 120L**



- ▶ **Features & Benefits:**
 - ◆ **AILE® 120L Flow rate:** 0-120L/m(1³/₁₆"")
AILE® 120LP Flow rate: 0-90 L/m (1")
Working Pressure: 0.18Mpa
 - ◆ **AILE® 120L Automatic Nozzles** for diesel, kerosene and all kinds of gasoline service.
 - ◆ **Even, smooth, spray pattern-** minimizes diesel foaming and false shut-offs.
 - ◆ **Three position hold-open device-** one finger control of hold-open mechanism means easy setting of flow rate.
 - ◆ **Easily replaced spout-** simply removes three screws. Replacement kits are available from AILE.
 - ◆ **Spout retaining ring-** adds extra measure in securing nozzle spout in fill pipe.
 - ◆ **Dual poppet valves-** easy to open nozzle against high pressure.
 - ◆ **Full hand insulator-** protects both nozzle and vehicle, and insulates users' hands.
 - ◆ **Available Colors** - color chart on inside back cover
 - ◆ **Selective Spout With Flowlock** - designed to shut-off automatically when the spout is tipped up, limiting spillage and " spit "
 - ◆ **100% Factory Tested.**

▶ **Warning:**

Do not use AILE-120L Nozzles with a hold-open device on prepay self-service installations.Using foreign objects to hold-open automatic nozzles could result in failure to shut-off and personal injury.

▶ **AILE® 120LP**



120L Series Of Automatic Shut-Off Nozzles

▶ **AILE® 120L Nozzle Shown**

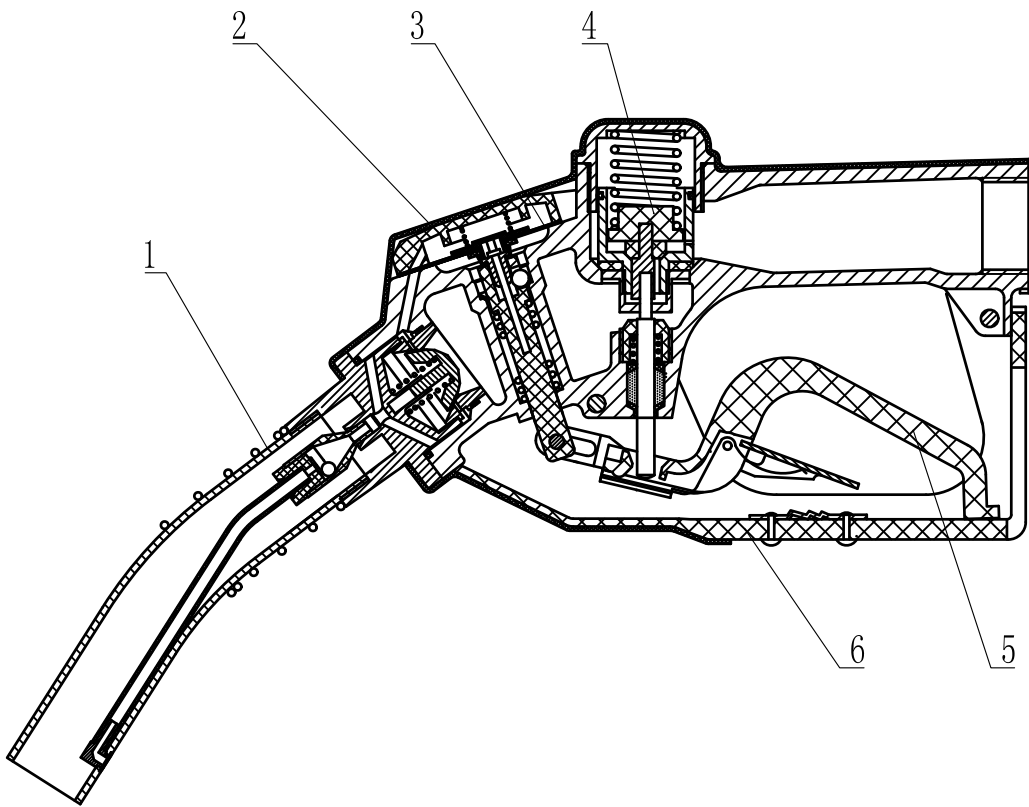

▶ **Important:**

AILE® Products should be used in compliance with country, province and local Laws and regulations. Products selection should be based on physical specifications and limitations and compatibility with the environment and materials to be handled. AILE Makes no warranty of fitness for a particular use. All illustrations and specifications in this literature are based on the latest products information available at the time of publication, AILE reserves the right to make changes at any time in price, materials. specifications and models and to discontinue models without notice or obligation.

▶ **Replacement Parts:**

Key	Description	AILE 120L	AILE 120LP
1	Spout 1"		◆
1	Spout 1 ³ / ₁₆ "	◆	
2	Full Hand Insulator	◆	◆
3	Diaphragm Assembly	◆	◆
4	Main Valve Assembly	◆	◆
5	Lever Assembly	◆	◆
6	Lever Guard	◆	◆



120LB Series Of Automatic Pressure-Sensitive Shut-Off Nozzles

- ▶ For Heavy-Duty, High-Flow Truck stop, Bus and Fleet Service If you operate a full-service petrol station,refuel your own fleet,or manage a card-lock refueling location, the low cost, long life and durability of the AILE 120LB high flow nozzle can help increase your productivity,sales and profits.

▶ **Materials:**
Body: Aluminum
Seals: Buna-N, Viton
Main stem seals:Viton Cased Oil Seal / Graphite with Teflon
Main stem: Stainless steel

▶ **Package:**
Net Weight: 1.6kg/pc
Gross Weight: 1.9kg/pc
45x40x32.5cm³/case of 10pc

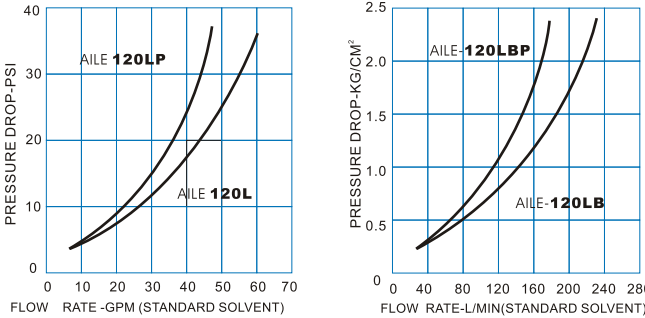

▶ **Ordering Specifications:**

Product #	Inlet size	Outlet diameter
120LB	NPT1" / BSP1"	1 3/16"
120LBP	NPT1" / BSP1"	1"

▶ **AILE®120LB**



▶ **Features & Benefits:**

- ◆ **AILE® 120LB Flow rate:** 0-120L/m(1¹³/₁₆"")
AILE® 120LBP Flow rate: 0-90 L/m (1")
Working Pressure: 0.18Mpa

◆ **AILE® 120LB Automatic Nozzles** for diesel, kerosene and all kinds of gasoline service.

◆ **Even, smooth, spray pattern-** minimizes diesel foaming and false shut-offs.

◆ **Exclusive Pressure Detecting Module-** the main valve can keep closed, even when held without enough pressure in hose.

◆ **Three position hold-open device-** one finger control of hold-open mechanism means easy setting of flow rate.

◆ **Easily replaced spout-** simply removes three screws. Replacement kits are available from AILE .

◆ **Spout retaining ring-** adds extra measure in securing nozzle spout in fill pipe.

◆ **Dual poppet valves-** easy to open nozzle against high pressure.

◆ **Full hand insulator-** protects both nozzle and vehicle, and insulates users' hands.

◆ **Available Colors-** color chart on inside back cover

◆ **Selective Spout With Flowlock -** designed to shut-off automatically when the spout is tipped up, limiting spillage and " spit "

◆ **100% Factory Tested.**

▶ **Warning:**

Do not use AILE 120LB Nozzles with a hold-open device on prepay self-service installations.Using foreign objects to hold-open automatic nozzles could result in failure to shut-off and personal injury.

▶ **AILE®120LBP**



120LB Series Of Automatic Pressure-Sensitive Shut-Off Nozzles

▶ **AILE® 120LB Nozzle Shown**

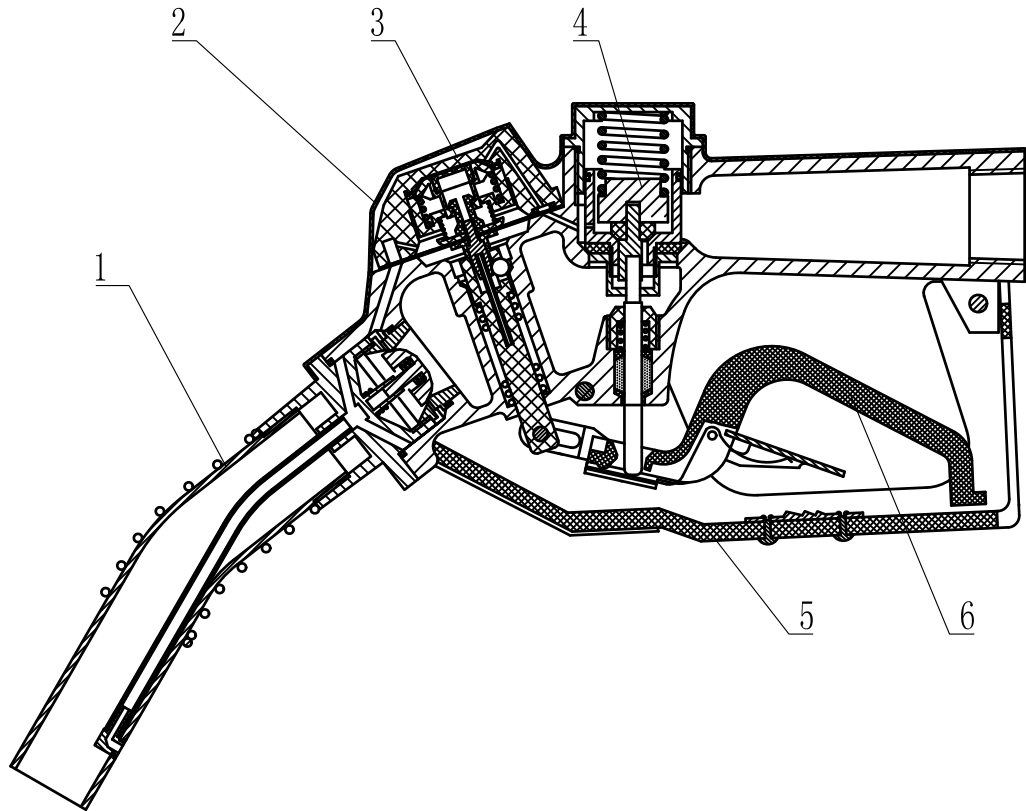

▶ **Important:**

AILE® Products should be used in compliance with country, province and local Laws and regulations. Products selection should be based on physical specifications and limitations and compatibility with the environment and materials to be handled. AILE Makes no warranty of fitness for a particular use. All illustrations and specifications in this literature are based on the latest products information available at the time of publication, AILE reserves the right to make changes at any time in price, materials. specifications and models and to discontinue models without notice or obligation.

▶ **Replacement Parts:**

Key	Description	AILE 120LB	AILE 120LBP
1	Spout 1"		◆
1	Spout 1 3/16"	◆	
2	Full Hand Insulator	◆	◆
3	Pressure Detecting Module	◆	◆
4	Main Valve Assembly	◆	◆
5	Lever Guard	◆	◆
6	Lever Assembly	◆	◆



A2111-15A Series Of Automatic Nozzles

► For petroleum station service with diesel, kerosene and all kinds of gasoline.AILE A2111-15A nozzle can help improve your efficiency.

► **Materials:**
Body: Aluminum
Seals: Buna-N, Viton
Main stem seals: Viton Cased Oil Seal
Main stem: Stainless steel

► **Package:**
Net Weight: 1.5kg/pc
Gross Weight: 1.8kg/pc
55x34x42.5 cm³/case of 15pc
37.5x34x43 cm³/case of 10pc

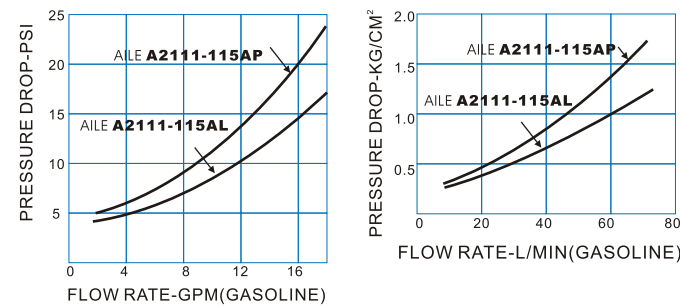

► **Ordering Specifications:**

Product #	Inlet size	Outlet diameter
A2111-15AP	NPT1" / BSP1"	13/16"
A2111-15AL	NPT1" / BSP1"	15/16"

► **AILE® A2111-15AP**



► **Features & Benefits:**

- ◆ **AILE® A2111-15AP** Flow rate: 0-45 L/m (¹³/₁₆")
AILE® A2111-15AL Flow rate: 0-60 L/m (¹⁵/₁₆")
Working Pressure: 0.18Mpa
- ◆ **AILE A2111-15A Automatic Nozzles**
For diesel , kerosene and all kinds of gasoline service.
- ◆ **Dual poppet valve-** easy to open nozzles against high inlet pressure.
- ◆ **Accurate flow control-** allows your customer to top off their tank to the exact amount they want and it's easy to stop gasoline flow precisely.
- ◆ **Low profile aluminum body-** light weight, easier to handle, provides an attractive, image enhancing appearance. High pressure casting technique reduce foaming and static electricity.
- ◆ **Easily replaced spout-** simply removes two screws. Spout kits are available from AILE.
- ◆ **Concealed hold-open rack-** means easy setting of flow rate.
- ◆ **Full hand insulator-** protects both nozzle and vehicle, and insulates users' hands.
- ◆ **Available Colors-** color chart on inside back cover
- ◆ **Selective splash guard.**
- ◆ **Selective Spout With Flowlock -** designed to shut-off automatically when the spout is tipped up, limiting spillage and " spit "
- ◆ **100% Factory Tested.**

► **Warning:**

Using foreign objects to hold open automatic nozzles could result in failure to shut-off and personal injury.

► **AILE® A2111-15AL**



A2111-15A Series Of Automatic Nozzles

► **AILE® A2111-15A Nozzle Shown**

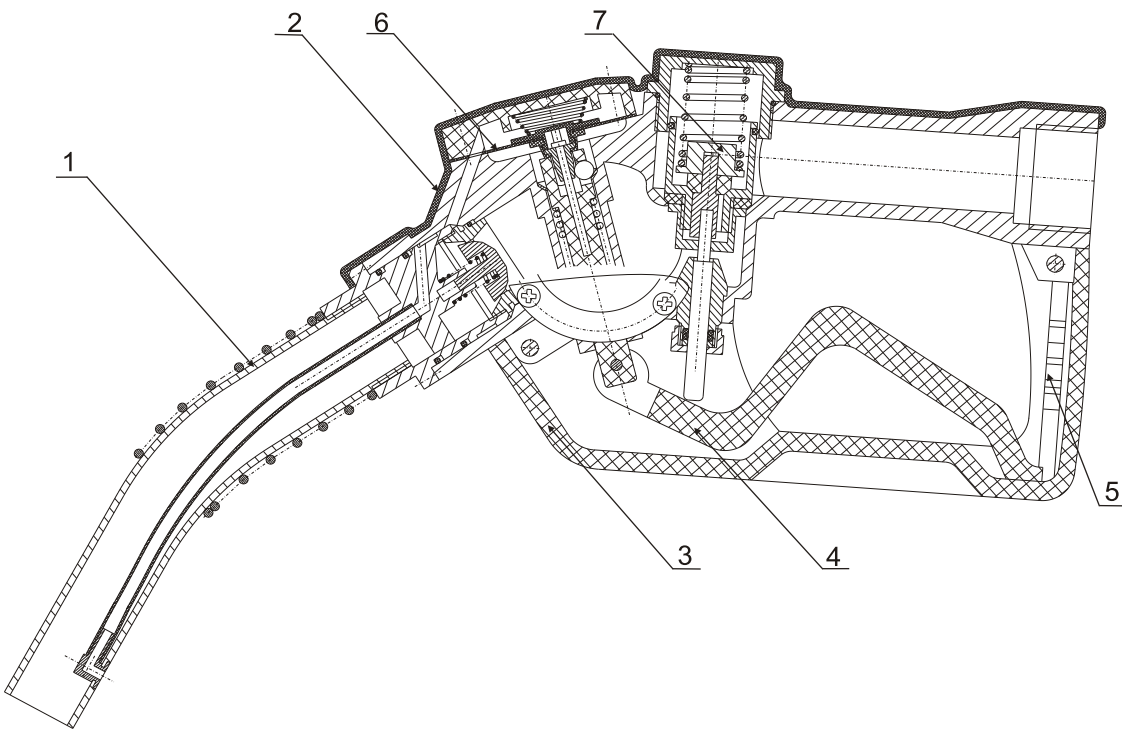

► **Important:**

AILE® Products should be used in compliance with country, province and local Laws and regulations. Products selection should be based on physical specifications and limitations and compatibility with the environment and materials to be handled. AILE Makes no warranty of fitness for a particular use. All illustrations and specifications in this literature are based on the latest products information available at the time of publication, AILE reserves the right to make changes at any time in price, materials, specifications and models and to discontinue models without notice or obligation.

► **Replacement Parts:**

Key	Description	A2111-15AL	A2111-15AP
1	Spout 13/16"		◆
1	Spout15/16"	◆	
2	Full Hand Insulator	◆	◆
3	Lever - Guard	◆	◆
4	Lever	◆	◆
5	Gear Plate	◆	◆
6	Diaphragm Assembly	◆	◆
7	Main Valve Assembly	◆	◆



ZYQ-13A Series Of Automatic Nozzles

► **AILE® ZYQ-13A** Automatic nozzles are designed for today's customers' ideals. Small, trim, light weight, easy and convenient to use. It is a rugged performer that offers long life and reliable service.

► **Materials:**
Body: Aluminum
Seals: Buna-N, Viton, Polyurethane
Main stem seals: Viton Cased Oil Seal
Main stem: Stainless steel

► **Package:**
Net Weight: 1.7kg/pc
Gross Weight: 2.0kg/pc
55x34x42.5 cm³/case of 15pc
37.5x34x43 cm³/case of 10pc

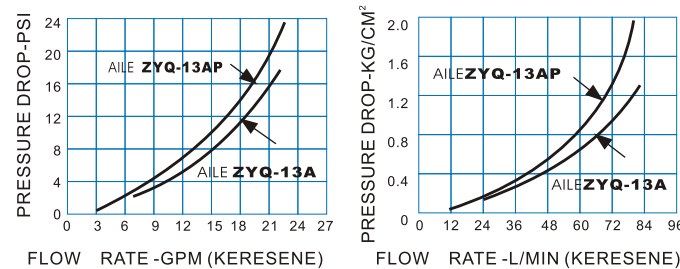

► **Ordering Specifications:**

Product #	Inlet size	Outlet diameter	Lever-Guard materials
ZYQ 13A	NPT3/4" / BSP3/4" / NPT1" / BSP1"	15/16"	PA66
ZYQ 13AP	NPT3/4" / BSP3/4" / NPT1" / BSP1"	13/16"	PA66
ZYQ 13A-L	NPT3/4" / BSP3/4" / NPT1" / BSP1"	15/16"	Aluminum
ZYQ 13AP-L	NPT3/4" / BSP3/4" / NPT1" / BSP1"	13/16"	Aluminum

► **AILE® ZYQ-13A**

► **AILE® ZYQ-13AP**

► **AILE® ZYQ-13AP-L**



► **Features & Benefits:**

- ◆ **AILE® ZYQ-13A** Flow rate: 0-70 L/m (¹⁵/₁₆")
AILE® ZYQ-13AP Flow rate: 0-45 L/m (¹³/₁₆")
- ◆ **Working Pressure:** 0.18Mpa
- ◆ **Compound Main valve and bleed poppet**
Tight structure, attractive appearance. Minimum pressure Loss and offer a maximum flow rate
- ◆ **Accurate flow control-**
It allows customers to top off their tank to the exact amount that they want , and it's easy to stop gasoline flow precisely.
- ◆ **Easily replaced 360° rotation swivel-** prevents the hose from curling up.
- ◆ **Hold-open rack is available for full-** service applications. The one hand control means easy setting to flow rate for customer's convenience.
- ◆ **Spout with gear:** Making it to be holding on the spout of tank without hand, improving your efficiency.
- ◆ **All nozzles with Flow-lock:** designed to shut-off automatically when the spout is tripped up, limiting spillage " spit " .
- ◆ **Hand insulator-** protects both nozzle and vehicle, and insulates users' hands.
- ◆ **Available Colors-** color chart on inside back cover
- ◆ **Selective splash guard.**
- ◆ **100% Factory Tested**

► **Warning:**

Using foreign objects to hold open automatic nozzles could result in failure to shut-off and personal injury.

ZYQ-13A Series Of Automatic Nozzles

► **AILE® ZYQ-13A Nozzle Shown**

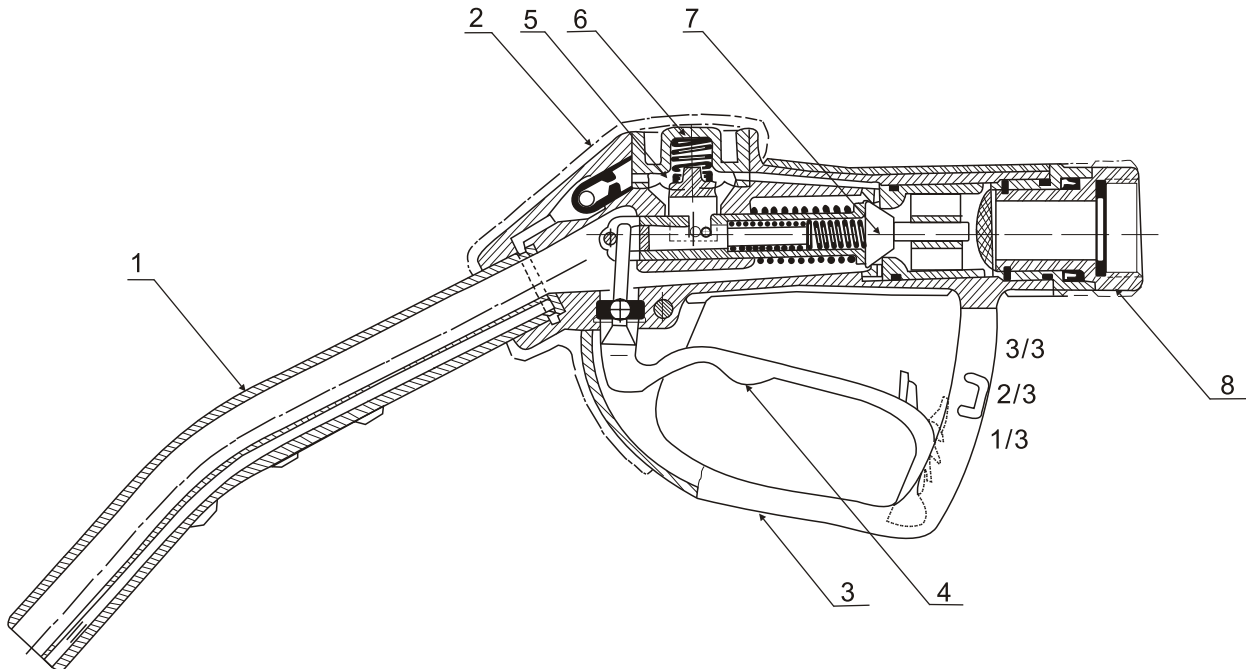

► **Important:**

AILE® Products should be used in compliance with country, province and local Laws and regulations. Products selection should be based on physical specifications and limitations and compatibility with the environment and materials to be handled. AILE Makes no warranty of fitness for a particular use. All illustrations and specifications in this literature are based on the latest products information available at the time of publication,AILE reserves the right to make changes at any time in price, materials, specifications and models and to discontinue models without notice or obligation.

► **Replacement Parts:**

Key	Description	ZYQ13A	ZYQ13AP
1	Spout 13/16"		◆
1	Spout 15/16"	◆	
2	Full Hand Insulator	◆	◆
3	Lever-Guard	◆	◆
4	Lever Assembly	◆	◆
5	Diaphragm Assembly	◆	◆
6	Vac Cap	◆	◆
7	Main Valve	◆	◆
8	Swivel BSP 3/4"/ NPT3/4"/ BSP 1"/ NPT1"	◆	◆



ZYQ-25A Series Of Automatic Nozzles

► **AILE®** ZYQ-25A Automatic nozzles are designed for today's customers' ideals.For Heavy-Duty, High-Flow Truck stop, Bus and Fleet Service.Light weight,easy and convenient to use.It is a rugged performer that offers long life and reliable service.

► **Materials:**
Body: Aluminum
Seals: Buna-N, Viton
Main stem seals: Viton Cased Oil Seal
Main stem: Stainless steel

► **Package:**
Net Weight: 1.6kg/pc
Gross Weight: 2.0kg/pc
55x34x32.2 cm³/case of 10pc

► **Ordering Specifications:**

Product #	Inlet size	Outlet diameter	Lever-Guard materials
ZYQ 25A-801	NPT1" male	1 3/16"	PA66
ZYQ 25A-802	NPT1" Female	1 3/16"	PA66
ZYQ 25A-803	BSPT1" male	1 3/16"	PA66
ZYQ 25A-804	BSPT1" Female	1 3/16"	PA66
ZYQ 25A-805	BSPP1" male	1 3/16"	PA66
ZYQ 25A-806	BSPP1" Female	1 3/16"	PA66
ZYQ 25A-L-821	NPT1" male	1 3/16"	Aluminum
ZYQ 25A-L-822	NPT1" Female	1 3/16"	Aluminum
ZYQ 25A-L-823	BSPT1" male	1 3/16"	Aluminum
ZYQ 25A-L-824	BSPT1" Female	1 3/16"	Aluminum
ZYQ 25A-L-825	BSPP1" male	1 3/16"	Aluminum
ZYQ 25A-L-826	BSPP1" Female	1 3/16"	Aluminum

► **Features & Benefits:**

- ◆ **AILE®** ZYQ-25A **Flow rate:** 0-120L/m(1³/₁₆")
- ◆ **Working Pressure:** 0.18Mpa
- ◆ **Compound Main valve and bleed poppet**
Tight structure, attractive appearance. Minimum pressure Loss and offer a maximum flow rate
- ◆ **Accurate flow control-**
It allows customers to top off their tank to the exact amount that they want , and it's easy to stop gasoline flow precisely.
- ◆ **Easily replaced 360° rotation swivel-** prevents the hose from curling up.
- ◆ **Hold-open rack is available for full-** service applications. The one hand control means easy setting to flow rate for customer's convenience.
- ◆ **Spout with gear:** Making it to be holding on the spout of tank without hand, improving your efficiency.
- ◆ **All nozzles with Flow-lock:** designed to shut-off automatically when the spout is tripped up, limiting spillage " spit " .
- ◆ **Hand insulator-** protects both nozzle and vehicle, and insulates users' hands.
- ◆ **100% Factory Tested**

► **Replacement Parts:**

Key	Description	ZYQ-25A
1	Spout 1 3/16"	
2	Hand Insulator	◆
3	Lever-Guard	◆
4	Lever Assembly	◆
5	Diaphragm Assembly	◆
6	Vac Cap	◆
7	Main Valve	◆
8	Swivel BSP 1"/ NPT1"	◆

► **AILE®** ZYQ-25A



► **AILE®** ZYQ-25A-L



► **AILE®** ZYQ-25A Nozzle Shown

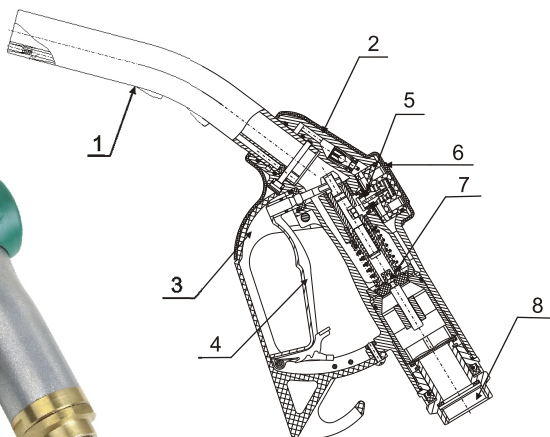

A1290 Automatic Shut-off Nozzle

► For Heavy-Duty, High-Flow Truck, Bus, and Home Fuel Oil Delivery Service.

► **Materials:**
Body: Cast aluminum
Seals: Buna-N,
Main stem : Stainless steel
Spout: Aluminum

► **Package:**
Net Weight: 3.25kg / pc
Gross Weight: 4kg /pc
44.2x33.5x40.7cm³/ case of 4pc

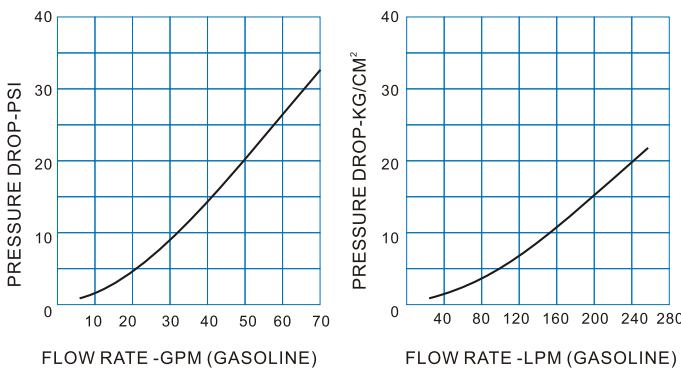

► **Ordering Specifications:**

Product #	Inlet size	Outlet diameter
1290-801	NPT1 1/2"	38mm
1290-802	BSPT1 1/2"	38mm

► **AILE®** A1290

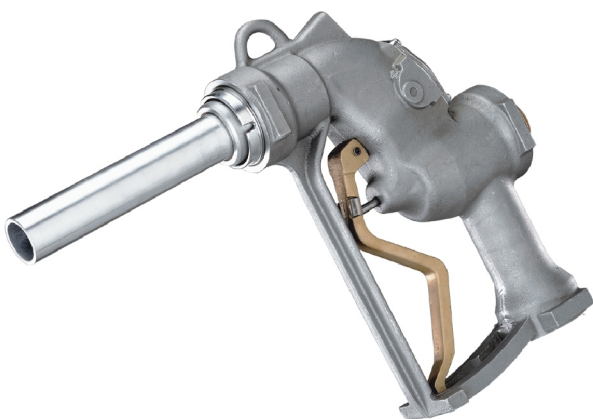

► **Features & Benefits:**

- ◆ **Aluminum Body-** Light weight and easy to operate.
- ◆ **Two-position hold-open device.**
- ◆ **One-hand control of hold-open mechanism-** means easy setting of flow rate.
- ◆ **Easily replaced spout-** simply removes the spout retainer nut.
- ◆ **Dual poppets-** make nozzle easy to open against high inlet pressure.
- ◆ **Right angle design-** provides large lever area for better grip and easier control,permitting the nozzle to fit into awkward space close to walls and into corners.
- ◆ **100% Factory Tested.**

► **Warning:**

Using foreign objects to hold open automatic nozzles could result in failure to shut-off and personal injury.

► **Replacement Parts:**

Key	Description
1	Spout Assembly
2	Diaphragm Assembly
3	Main Valve Assembly
4	Lever
5	Body

► **AILE®** A1290 Nozzle Shown

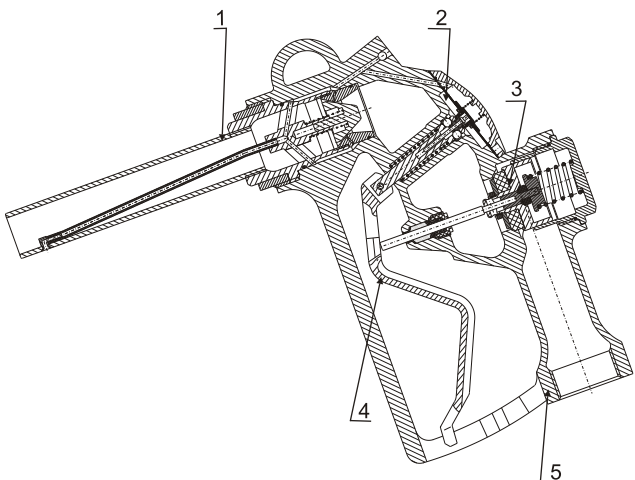

Nozzle Assemblies



► All **AILE®** Automatic Nozzles are furnished complete with a full PVC hand insulator. Available in a variety of colors, It is easy to match new color scheme or replace soiled insulators without removing the nozzle from the hose.

► **Ordering Specifications:**

Product#	Used On	Price
11A-C01	A2101-11A&AP	
11A-C02	A2101-11A&AP(No Mark)	
11B-C03	A2101-11B&BP	
11B-C04	A2101-11B&BP(Half Cover)	
11A-C05	A2000-11A&AP / 2001-11A&AP	

► **Ordering Specifications:**

Product#	Used On	Price
15A-C06	A2111-15A & AP &AL	
120L-C07	AILE-120L & LP	
120LB-C08	AILE-120LB & LBP	

► **Ordering Specifications:**

Product#	Used On	Price
13A-C08	ZYQ-13A & AP	
11VAI-C09	11VAI	
Splash Guard	11A/ 11AP / 11B / 11BP / 13A/ 13AP	

► **AILE®** Splash Guard-it also enhances the apperance of your nozzle, and makes dispensing gasoline more pleasant for your customers. It wonnot deform or crack in cold weather.



Nozzle Assemblies



► **AILE®** Automatic Nozzle Diaphragm Assembly

► **Ordering Specifications:**

Product#	Used On	Price
Da01	A2101-11A&AP / 120L & LP	
DA02	A2001-11A&AP / A2000-11A & AP	
DA03	ZYQ-13A & AP	
DA04	A2111-15A & AL & AP	
DA05	A1290	
DA06	A2101-11B&BP / 120LB & LBP	

► **AILE®** Lever & Lever-Guard Assembly

► **Ordering Specifications:**

Product#	Used On	Price
GR01	A2101-11A&AP A2101-11B&11BP 120L & LP&LB&LBP	
GR02	ZYQ-13A & AP	
HA03	ZYQ-13A & AP	
VAI-C04	11VAI	
LEV01	A2101-11A&AP A2101-11B&11BP 120L & LP&LB&LBP	
LEV02	ZYQ-13A & AP	



Series Of Spouts

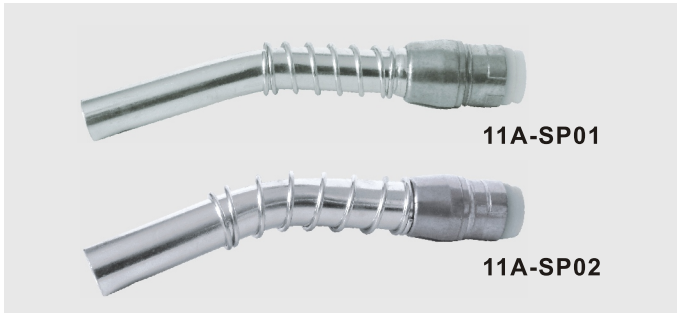

11A-SP01

11A-SP02

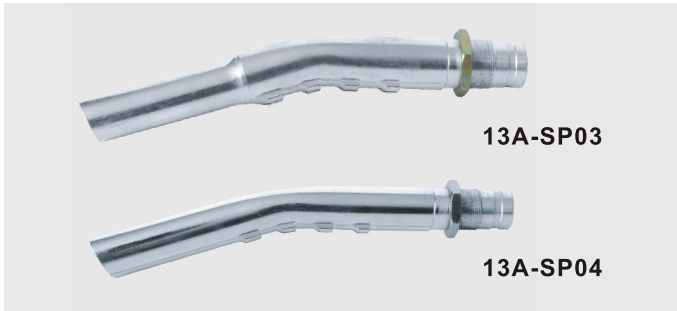

13A-SP03

13A-SP04

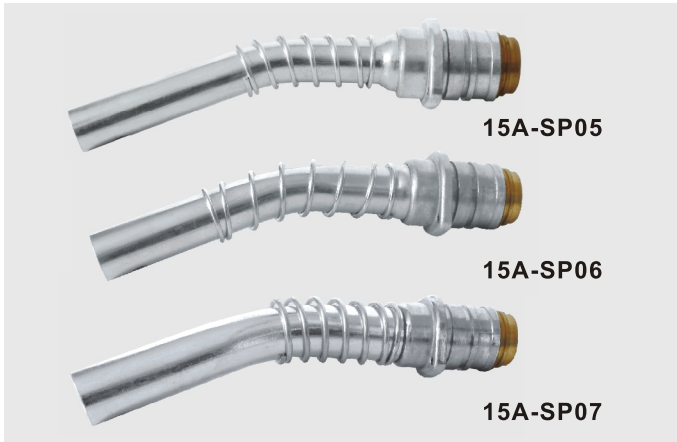

15A-SP05

15A-SP06

15A-SP07

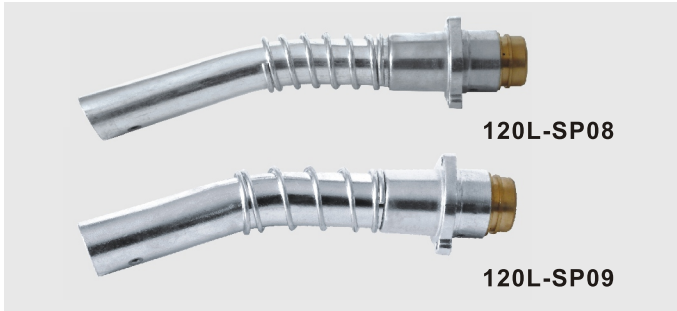

120L-SP08

120L-SP09

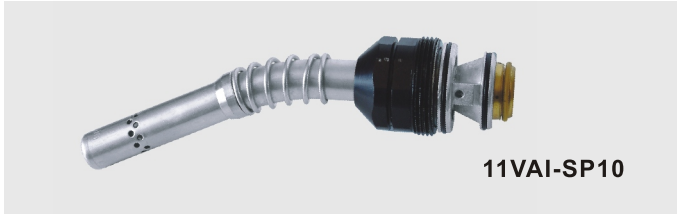

11VAI-SP10

- ▶ ALLE series nozzles can be continuously used by replacing the spout.
- ▶ **11A-SP01、11A-SP02 Package:**
Net Weight: 0.21kg/pc
Gross Weight: 0.25kg/pc
56x23.5x40cm³/case of 100pc
- ▶ **13A-SP03、13A-SP04 Package:**
Net Weight: 0.18kg/pc
Gross Weight: 0.22kg / pc
56x23.5x40cm³/case of 100pc
- ▶ **15A-SP05、15A-SP06、15A-SP07 Package:**
Net Weight: 0.255kg/pc
Gross Weight: 0.32kg / pc
56.5x23.5x38.5cm³/case of 50pc
- ▶ **120L-SP08、120L-SP09 Package:**
Net Weight: 0.34kg/pc
Gross Weight: 0.4kg / pc
56.5x23.5x38.5cm³/case of 50pc
- ▶ **11VAI-SP10 Package:**
Net Weight: 0.4kg/pc
Gross Weight: 0.46kg / pc
23.5x60x31cm³/case of 50pc

Ordering Specifications:

Product#	Used On	Outlet Size	Price
11A-SP01	A2101-11AP&BP	13/16"	
	A2000-11AP		
	A2001-11AP		
11A-SP02	A2101-11A&B	15/16"	
	A2000-11A		
	A2001-11A		
13A-SP03	ZYQ-13AP	13/16"	
13A-SP04	ZYQ-13A	15/16"	
15A-SP05	A2111-15Ap	13/16"	
15A-SP06	A2111-15AL	15/16"	
15A-SP07	A2111-15A	1"	
120L-SP08	120LP&LBP	1"	
120L-SP09	120L&LB	1 ¹³ / ₁₆ "	
11VAI-SP10	11VAI	13/16"	

Manual
Nozzles

• Automatic nozzles series



12A Series Of Manual Nozzles

- ▶ Nozzle Used for Utility fueling application (gravity or low pressure).

▶ **Materials:**
Body: Cast aluminum
Seals: Buna-N,
Main stem : Stainless steel
Spout: Aluminum

▶ **Package:**
Net Weight: 0.57kg/pc
Gross Weight: 0.725kg/pc
56x33.2x33.7cm³/case of 20pc
- ▶ **Features & Benefits:**
◆ Flow rate: 0-45 L/m (¹³/₁₆")
0-60 L/m (¹⁵/₁₆")
◆ Working Pressure: 0.18Mpa
◆ Aluminum Body- Light weight and easy to operate.
◆ Compound lever- two fulcrum points permit nozzle to be easily and slowly opened, then quickly opened fully. Makes topping off easy.
◆ 100% Factory Tested.

▶ Ordering Specifications:

Product #	Inlet size	Outlet diameter
12A-801	NPT1"	15/16"
12A-802	NPT1"	13/16"
12A-803	NPT3/4"	15/16"
12A-804	NPT3/4"	13/16"
12A-805	BSPP1"	15/16"
12A-806	BSPP1"	13/16"
12A-807	BSPP3/4"	15/16"
12A-808	BSPP3/4"	13/16"



▶ AILE[®] 12A



13A Series Of Manual Nozzles

- ▶ Nozzle Used for Utility fueling application (gravity or low pressure).

▶ **Materials:**
Body: Cast aluminum
Seals: Buna-N,
Main stem : Stainless steel
Spout: Aluminum

▶ **Package:**
Net Weight: 0.85kg/pc
Gross Weight: 1.07kg/pc
55x34x42.5 cm³/case of 15pc
- ▶ **Features & Benefits:**
◆ Flow rate: 0-45 L/m (¹³/₁₆")
0-70 L/m (1")
◆ Aluminum Body- Light weight and easy to operate.
◆ Compound lever- two fulcrum points permit nozzle to be easily and slowly opened, then quickly opened fully. Makes topping off easy.
◆ Rotary 360 inlet swivel- prevents hose from curling up.
◆ Selective concealed full hold-open rack- means easy to setting of flow rate.
◆ 100% Factory Tested.

▶ Ordering Specifications:

Product #	Inlet size	Outlet diameter
13A-01	NPT1"	13/16"
13A-02	NPT1"	1"
13A-03	BSPT1"	13/16"
13A-04	BSPT1"	1"
13A-05	NPT3/4"	13/16"
13A-06	NPT3/4"	1"
13A-07	BSPP3/4"	13/16"
13A-08	BSPP3/4"	1"

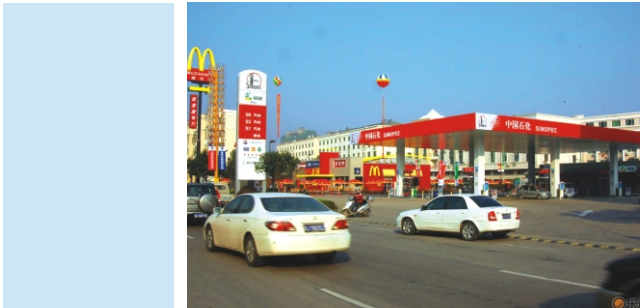

▶ AILE[®] 13A



A1250 Series Of Manual High-Flow Nozzles

- For High-Flow, Bulk Fuel Oil Delivery Service.

► **Materials:**
Body: Cast aluminum
Seals: Buna-N, Viton
Main stem : Stainless steel
Spout: Aluminum

► **Package:**
Net Weight: 2.08kg/pc
Gross Weight: 2.5kg/pc
46x43x35.5 cm³/case of 8pc
- **Features & Benefits:**

 - ◆ Flow rate: 0-260 L/m (1⁵/₈")
 - ◆ Working Pressure: 0.18Mpa
 - ◆ Aluminum Body- Light weight and easy to operate.
 - ◆ Replaceable hold-open rack- one-hand- control of hold-open mechanism means easy setting of flow rate. Nozzle must be attended at all times during usage.
 - ◆ 100% Factory Tested.

► **Ordering Specifications:**

Product #	Inlet size	Outlet diameter
A1250-801	BSPP1 1/2"	1 5/8"
A1250-802	NPT1 1/2"	1 5/8"



► **AILE® A1250**



A1295 Series Of Manual High-Flow Nozzles

- For High-Flow, Bulk Fuel Oil Delivery Service.

► **Materials:**
Body: Cast aluminum
Seals: Buna-N, Viton
Main stem : Brass
Spout: Aluminum

► **Package:**
Net Weight: 1.525kg/pc
Gross Weight: 1.875kg/pc
47x38.5x35 cm³/ case of 8pc
- **Features & Benefits:**

 - ◆ Flow rate: 0-290 L/m (1¹⁰/₁₃")
 - ◆ Working Pressure: 0.18Mpa
 - ◆ Aluminum Body- Light weight and easy to operate.
 - ◆ Replaceable hold-open rack- one-hand- control of hold-open mechanism means easy setting of flow rate. Nozzle must be attended at all times during usage
 - ◆ Replaceable composite lever guard- easy, low cost replacement should be guard be broken.
 - ◆ Easily replaced swivel- it can change the connecting between different thread and different caliber.
 - ◆ 100% Factory Tested.

► **Ordering Specifications:**

Product #	Inlet size	Outlet diameter
A1295-801	NPT1 1/2"	1 10/13"
A1295-802	NPT2"	1 10/13"
A1295-804	BSPT1 1/2"	1 10/13"
A1295-805	BSPT 2"	1 10/13"
A1295-807	BSPP1 1/2"	1 10/13"
A1295-808	BSPP 2"	1 10/13"



► **AILE® A1295**

